

4

3

2

1

THIS DOCUMENT CONTAINS PROPRIETARY INFORMATION AND EXCEPT WITH WRITTEN PERMISSION BY AGM CONTAINER CONTROLS, INC. SUCH INFORMATION SHALL NOT BE PUBLISHED, DISCLOSED TO OTHERS OR USED FOR ANY PURPOSE AND THE DOCUMENT SHALL NOT BE DUPLICATED IN WHOLE OR IN PART.

REVISIONS				
ZONE	LTR.	DESCRIPTION	DATE	APPROVED
--	B	SALES DRAWING CREATED WITH REV B. 12-13-05 EHB	12-13-05	PML
--	C	UPDATED IAW DCN#06-011. 2-23-06 EHB	3-21-06	PML

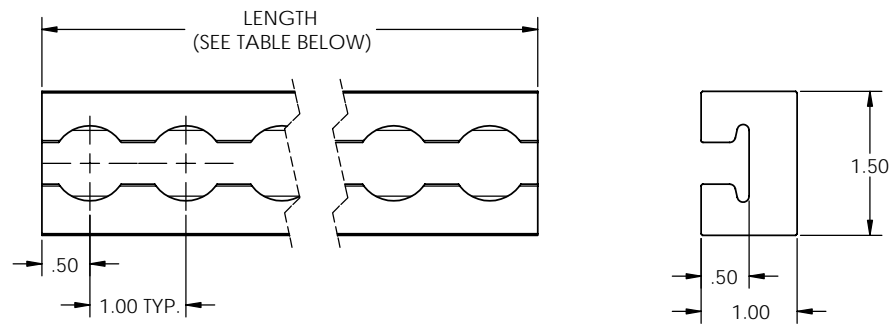

NOTES UNLESS OTHERWISE SPECIFIED:

- MATERIAL: ALUMINUM ALLOY 5083-H111 IAW SAE AMS QQ-A-200/4 OR 5086-H111 IAW SAE AMS QQ-A-200/5. ALTERNATE SPECIFICATIONS: ASTM B221 OR ASTM B241.
- TRACK MAY BE SUPPLIED IN ADDITIONAL LENGTHS THAN LISTED IN TABLE BELOW. CONTACT AGM CONTAINER CONTROLS, INC. ENGINEERING TO SPECIFY LENGTH.
- TRACK MAY BE SUPPLIED WITH MOUNTING HOLES FOR BOLTING TO STEEL STRUCTURE. CONTACT AGM CONTAINER CONTROLS, INC. ENGINEERING TO SPECIFY HOLE PATTERN.

SPECIFICATION CONTROL DRAWING

PART NUMBER	LENGTH ±.06
825012-3000	30.00
825012-3600	36.00
825012-4200	42.00
825012-4800	48.00
825012-5400	54.00
825012-6000	60.00
825012-6600	66.00
825012-7200	72.00

INTERPRET DIMENSIONS AND TOLERANCES IAW ANSI Y14.5M-1994				CONTRACT	
UNLESS OTHERWISE SPECIFIED DIMENSIONS ARE IN INCHES				DRAWN	DATE
TOLERANCES:				E.BINNIE	12-13-05
DECIMALS	XX ± .015	ANGLES	± .5°	CHECK	
XXX ± .010				P.LANE	12-13-05
DO NOT SCALE DRAWING				APPROVED	
FINISH:				P.LANE	12-13-05
MANUFACTURING				CUSTOMER	
PART DASH NO.	NEXT QTY. REC'D PER ASSY.	FINAL	NEXT ASSY.	USED ON	SIMILAR TO
APPLICATION			ACT. WT.	CALC. WT.	

agm CONTAINER CONTROLS, INC.				
P.O. BOX 40020 - TUCSON, ARIZONA 85717-0020				
TITLE				
TRACK				
SIZE	FSCM NO.	DWG. NO.	REV	
C	08992	825012	C	
SCALE	1/1	RELEASE DATE	SHEET	1 OF 1

4

3

2

1